

MISSOURI GEOGRAPHIC REFERENCE SYSTEM

MISSOURI DEPARTMENT OF NATURAL RESOURCES

DIVISION OF GEOLOGY AND LAND SURVEY

LAND SURVEY PROGRAM

PO Box 250, Rolla, Missouri 65402, (573) 368-2300

STATION NAME: St Joe Reset PID: KE1543

COUNTY: Buchanan STATE: Missouri
 TOWNSHIP: 58 NORTH, RANGE: 35 WEST, SECTION: SE 1/4 OF 30
 USGS 7.5' QUAD: St Joseph North
 DATE MONUMENTED: 1979 MONUMENTED BY: NGS

TECHNICAL DATA TABLE:

(All data in meters 1 meter = 3.28083333 feet)

HORIZONTAL: NAD 1983	VERTICAL: NAVD 1988
DATE OF OBSERVATIONS: 1996	DATE OF OBSERVATIONS: 1996
DATE OF ADJUSTMENT: 2000	DATE OF ADJUSTMENT: 2000
ORDER: 1st	ORDER:
LATITUDE: 39°48'33.33842"	ELEVATION: 346.6
LONGITUDE: 94°52'10.76084"	ELLIPSOID HEIGHT: 314.78

MISSOURI COORDINATE SYSTEM 1983:

NORTH (Y): 404356.202
 EAST (X): 818347.835
 ZONE: West
 CONVERGENCE: -00°14'12"
 GRID FACTOR: .9999042

AZIMUTH INFORMATION:

STATION: St. Joe Reset AZIMUTH MARK: St. Joe Reset RM #3
 GEODETIC:
 ASTRONOMIC: 72°21'33"
 GRID: 72°35'45"

REMARKS

The HORIZONTAL POSITION was determined by GPS observations and adjusted by the National Geodetic Survey in February 2000.

The ELEVATION was determined by GPS observations.

The ELLIPSOID HEIGHT was determined by GPS observations referenced to NAD83.

GEOID 99 was used in determining ELEVATION and ELLIPSOID HEIGHT.

STATION: St Joe Reset

DESCRIPTION: The station mark is an NGS disk stamped "St Joe MORC 1934 1979". The disk has been defaced and is not legible.

STATION, AZIMUTH MARKS AND REFERENCE TIES: The station is on the west side of a parking area about 0.15 mile into the Mo Department of Conservation Sunbridge Hills Natural area west of Huntoon Road in the northwest part of St. Joseph, Mo. It is 53.6 feet southwest of RM #1; 14.2 feet southwest of a nail and shiner in an 8 inch treated post on the south side of the road to the Lilliger Cemetery; 23.5 feet south of the center of the cemetery road and 60.7 feet of southeast of RM #2. RM #1 is 53.6 feet northeast of the station; 30 feet north of the cemetery road; and 76.0 feet east of RM #2. RM #2 is 60.7 feet northwest of the station; about 10 feet south of the cemetery road and on a small mound about 1.5 feet higher than the station.

Azimuth Mark 1934 has not been visible since before 1958 due to trees. RM #3 was set with 3rd order position in 1979 and serves as azimuth. It is 478+ feet northeast; 100 feet west of an iron pipe gate; 50 feet north of the drive between parking areas; 2 feet east of a metal witness post and 2 feet west of another.

STATION & AZIMUTH MARK TO REACH: To reach the station from the center line of I-229 Exit 7 (Hiland Ave.) in the northwest part of St. Joseph, Mo, go northeast on Hiland Ave. for 0.15 mile to Huntoon Rd. Turn left and follow Huntoon Road. northerly for 2.0 miles (crossing I-229 at 1.35 mile) to Department of Conservation entrance to first parking area for Sunbridge Hills Natural History Area on the left. Turn left and follow gravel road up hill to west through gate and south for 0.15 mile to second parking area and station in Y of road.

SPECIAL INFORMATION: Table for St Joe Reset

Mark	Agency	Stamping	Description
Station	NGS	St Joe MORC 1934 1979	12" round conc. projects 1"
RM #1	CGS	St Joe MRC NO 1 1934	12" square conc. projects 3"
RM #2	CGS	St Joe MRC NO 2 1934	12" square conc. projects 2"
RM #3	NGS	St Joe MORC 1934 NO 3 1979	11" round projects 3"

SUPERSEDED SURVEY CONTROL

NGS NAD 83(1997)-	39°48'33.33841"(N)	94°52'10.76085"(W)
NGS NAD 83(1997)-	39°48'33.33841"(N)	94°52'10.76085"(W)
NGS NAD 83(1986)-	39°48'33.34064"(N)	94°52'10.75527"(W)
NGS NAD 83(1986)-	39°48'33.34064"(N)	94°52'10.75526"(W)

DATE of REPORT 2002

STATION: St. Joe Reset

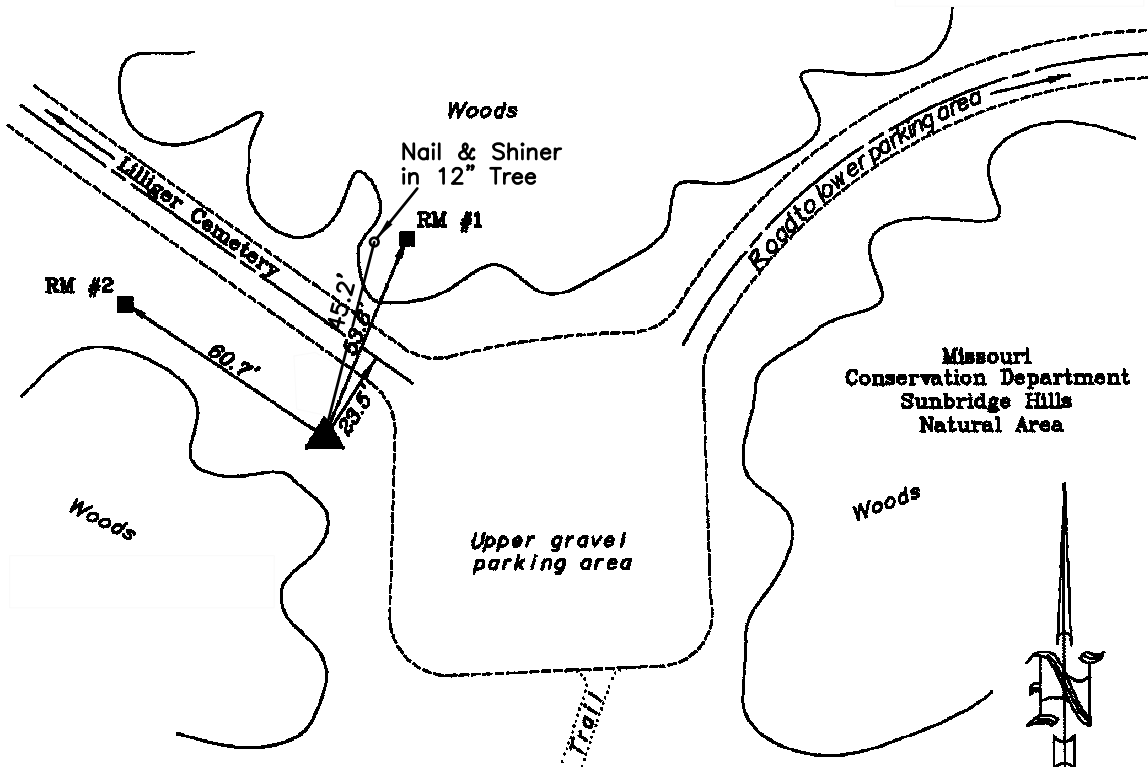

AZIMUTH MARK: St. Joe RM #3

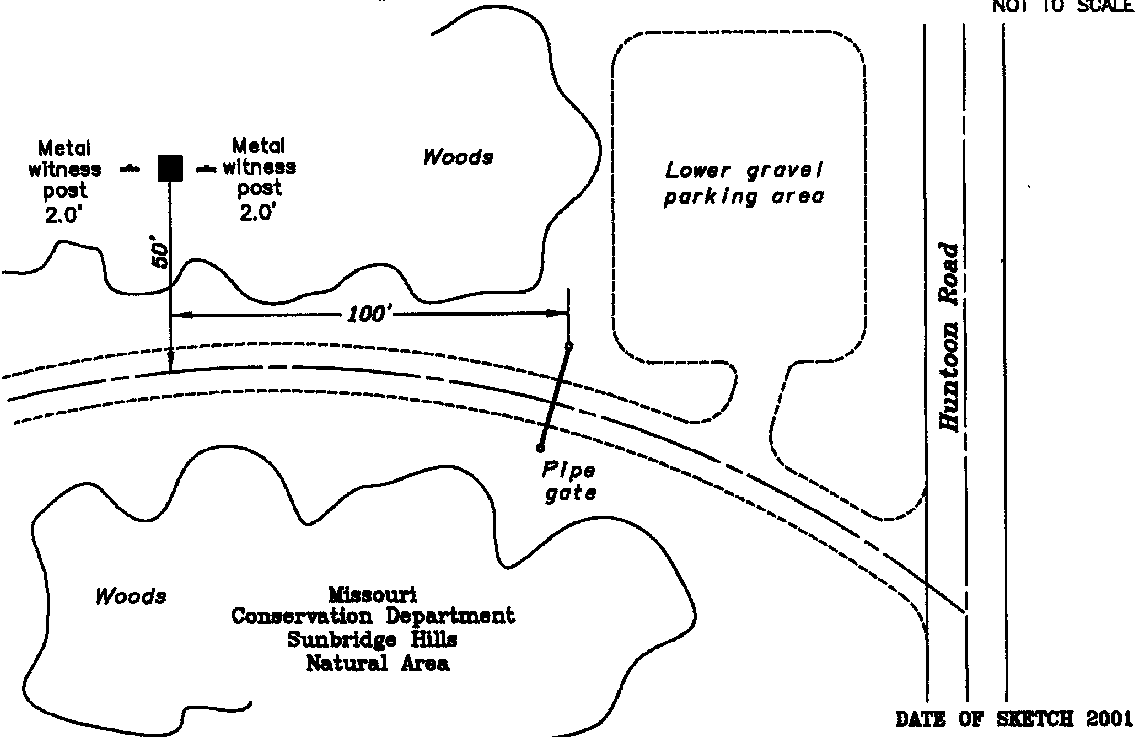

NOT TO SCALE

DATE OF SKETCH 2001



STATION: ST. JOE RESET (LOOKING NORTH)



STATION: ST. JOE RESET (LOOKING EAST)